

GIR...UK GIR...UK..-2RS Series

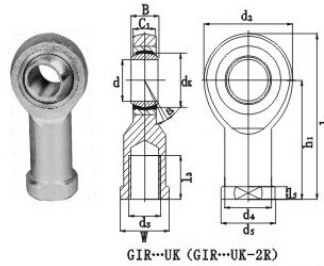
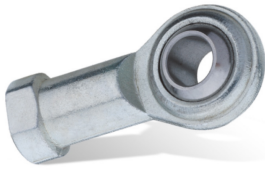

select	Inquiry	Bearing No.	Boundary dimensions [mm]														Basic load ratings(kN)		Mass Kg
			d	d3	B	C1 max	d2 max	l3 min	W	d4 max	d5 max	l5 max	h1	l4 max	dk	$\alpha' \approx$	Dynamic(Cr)	Static(Cor)	
GIR6UK	6	M6	6	4.4	21	11	11	10	13	5	30	40.5	10	13	3.6	8.15	0.021		
GIR8UK	8	M8	8	6	24	15	14	12.5	16	5	36	48	13	15	5.85	12.9	0.039		
GIR10UK	10	M10	9	7	29	20	17	15	19	6.5	43	57.5	16	12	8.65	17.6	0.061		
GIR12UK	12	M12	10	8	34	23	19	17.5	22	6.5	50	67	18	11	11.4	24.5	0.096		
GIR15UK	15	M14	12	10	40	30	22	21	26	8	61	81	22	8	17.6	36	0.18		
GIR17UK	17	M16	14	11	46	34	27	24	30	10	67	90	25	10	22.4	45	0.22		
GIR20UK	20	M20	16	13	53	40	32	27.5	35	10	77	103.5	29	9	31.5	60	0.35		
GIR25UK	25	M24	20	17	64	48	36	33.5	42	12	94	126	35.5	7	51	83	0.64		
GIR30UK	30	M30	22	19	73	56	41	40	50	15	110	146.5	40.7	6	66.5	110	0.93		
GIR35UK-2RS	35	M36	25	21	82	60	50	47	58	15	125	166	47	6	112	146	1.3		
GIR40UK-2RS	40	M39	28	23	92	65	55	52	65	18	142	188	53	7	140	180	2		
GIR45UK-2RS	45	M42	32	27	102	65	60	58	70	20	145	196	60	7	180	240	2.5		
GIR50UK-2RS	50	M45	35	30	112	68	65	62	75	20	160	216	66	6	220	290	3.5		
GIR60UK-2RS	60	M52	44	38	135	70	75	70	88	20	175	242.5	80	6	345	450	5.5		
GIR70UK-2RS	70	M56	49	42	160	80	85	80	98	20	200	280	92	6	440	610	8.6		
GIR80UK-2RS	80	M64	55	47	180	85	100	95	110	25	230	320	105	6	570	750	12		